

- Proposed Speed Zone 50kph to 30kph
- Proposed Speed Zone 70kph to 50kph
- Proposed Speed Zone 40kph School Zone

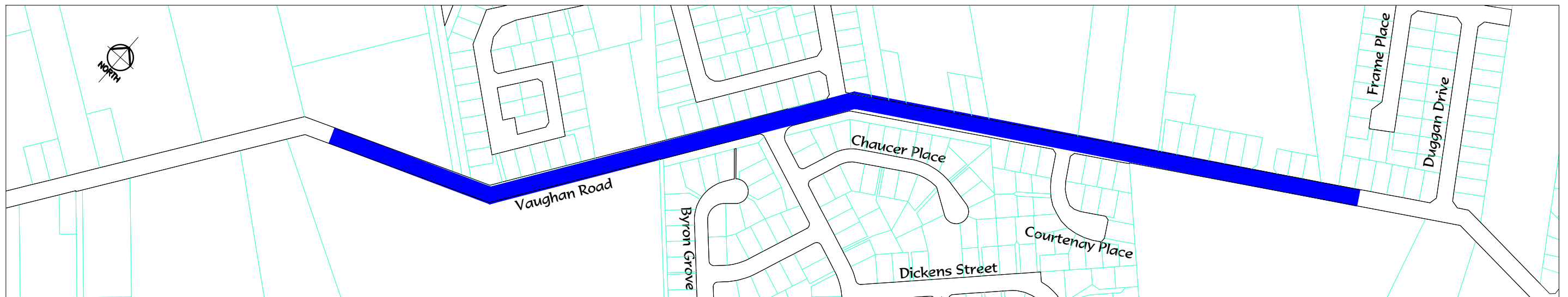
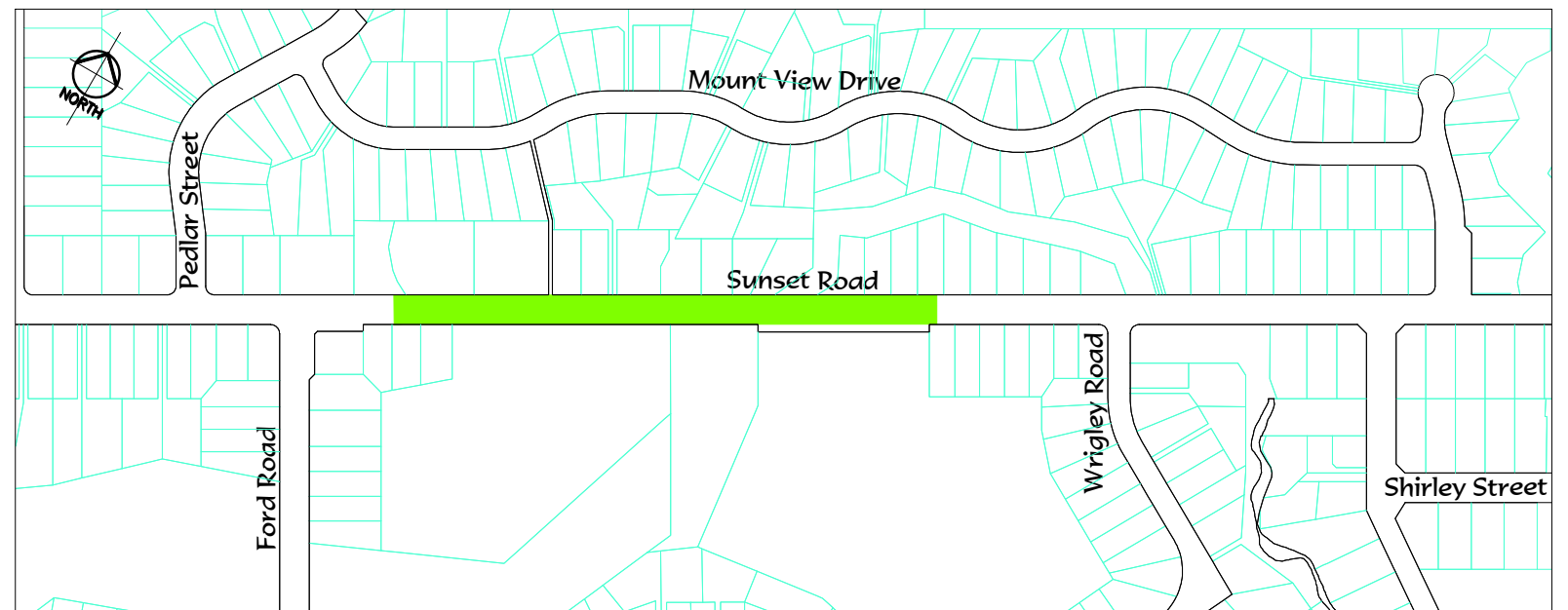
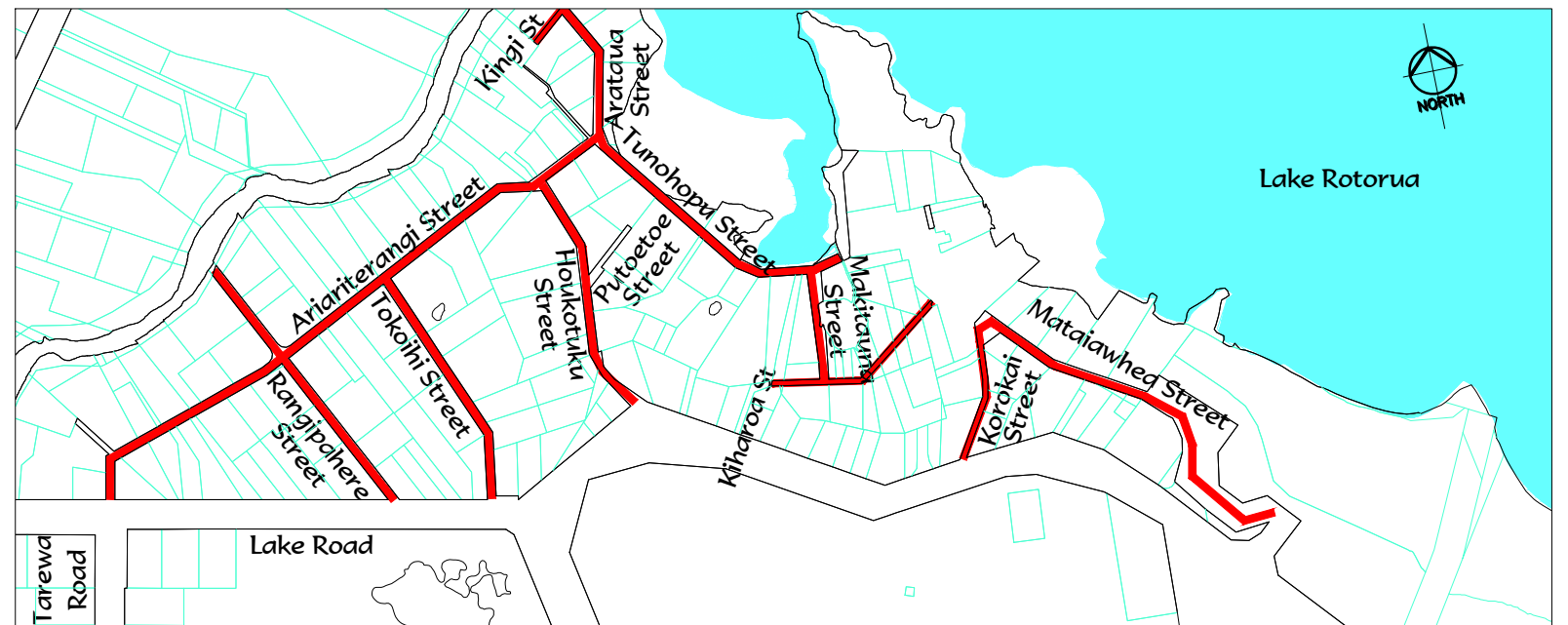

DISCLAIMER
The services shown on this plan are indicative only. The Rotorua District Council accepts no responsibility for the accuracy of their detail and location. The Contractor shall consult with all appropriate authorities for services information prior to excavation.

No.	AMENDMENTS	DATE

This design and drawing is the COPYRIGHT of the ROTORUA DISTRICT COUNCIL and shall not be reproduced without written permission

SCALE	1:2500 @ A1	L.B.
		F.B.
FIELDWORK		
DESIGNED	ELIZABETH WOOD	11/09
DRAWN	GRANT CHRYSTIE	11/09
TRACED		
CHECKED		
RECOMMENDED		

NOT FOR CONSTRUCTION	

SPEED LIMIT BYLAW
2009

PROPOSED AREA'S OF SPEED
LIMITS TO BE AMENDED

PLAN

ROTORUA DISTRICT COUNCIL
ENGINEERS DEPARTMENT
PRIVATE BAG
ROTORUA

Telephone 07 348 4199 Facsimile 07 346 3143

DESTINATION
ROTORUA
MUNICIPALITY
CONTRACT

DRAWING No.
12732

SHEET No 001 OF 001